

CELEBRATING THE CHALLENGES

2011

Different Isn't So Different Anymore



Sponsored by:

**The Special Education Council
of the
Alberta Teachers' Association**

"Meeting the needs of all children"

Thursday October 13 – Saturday October 15, 2011

The Lodge at Kananaskis

WELCOME

It is with great pleasure to welcome you to Celebrating the Challenges Conference 2011. I hope that the conference will be a rewarding and a fulfilling experience and help you learn to work with some new directions in which our work continues to be moving. One of the most appealing elements of Celebrating the Challenges is the sense of community among delegates. Our delegates bring to the conference a broad range of ideas and experiences. Learning would not be complete without great opportunities for networking.

Celebrating the Challenges provides you with plenty of opportunities where you can meet new colleagues, get re-acquainted with old ones and find out about a wide array of practices from schools across our province. This conference is a further opportunity to come together and talk about how to build the best possible education system. You will hear from innovators and educators and share strategies on how to turn great ideas into action. Education is changing. Our kids live in a complex and fast-moving world and we all want to do everything we can to help them succeed.

Different isn't so different anymore! It's short, it's clear and it's catchy! Few can accurately predict what the coming year will bring. I'll hazard a safe guess and say that it will be very busy. To meet each challenge and ride the waves of change, I would recommend considering this: take the time to find renewal of purpose and direction but don't forget to also celebrate the achievements of those around you, as well as yourself - celebrate the challenges and remember that different isn't so different anymore! The conference is all about celebrating those differences. The conference committee firmly believes that there is no more challenging, no nobler, and no more important calling than educating a child.

On behalf of the conference committee and myself, thank you for your energy in dedicating yourselves to children and their future.

Darci Fulton
Conference Director 2011

CONFERENCE SESSIONS

The following strands have been selected to address topics that support Alberta Education's vision of one inclusive system through curriculum, capacity and collaboration. Discuss these important topics with experts and colleagues from all corners of our great province!

Strand 1: Technology

Strand 2: Mental Health and Behavior

Strand 3: Supporting the Learner: UDL, DI and Personalization

Strand 4: Diversity and Culture

Strand 5: Exceptional Needs



**Celebrating
the
Challenges**

2011 Conference Reminders

Please visit our **NEW Special Education Council** website at
www.specialeducation.ab.ca

Please **wear your lanyard at all times** for access to all sessions and
socials.

**ALL sessions are first come, first serve. If you arrive at a session and it is
full, please go quickly to your second choice session.**

All conference delegates may pick up their boxed lunch on Friday at the
Grappa Room. Lunch vouchers are inside your delegate package.

Special Education Council Annual General Meeting

On Saturday, October 15, from 8:00 - 9:00 a.m. in the Bighorn Lounge, Delta Lodge, join the
Executive of the Special Education Council. This **meeting** includes:

- Complimentary continental breakfast
- Annual Report of the Council
- Treasurer's Report
- Election of Table Officers

PRIZE: Win a free registration to Celebrating the Challenges Conference 2012!

THANK YOU

Special Education Council Executive for their assistance at the Conference

Alberta Regional Consortia for Speaker Sponsorship

Learning Links for Speaker Sponsorship

Calgary Public School Board and **Red Deer Public School Board** for supporting the
Conference Committee in their duties.

Conference 2011 Schedule at a Glance

PRE-CONFERENCE

Wednesday, October 12, 2011

6:00 p.m. - 9:00 p.m.

Pre-Conference Registration

Thursday, October 13, 2011

7:30 a.m. ó 9:00 a.m.

Pre-Conference Registration

7:30 a.m. ó 8:30 a.m.

Continental Breakfast (included)

8:30 a.m. - 11:45 a.m.

SESSION A: "Learning Coaches @ Work: Structuring Coaching for Effectiveness": Joellen Killion

11:45 a.m. - 1:00 p.m.

SESSION B: "Differentiating Differentiated Curriculum": Dr. Lannie Kanevsky

1:00 p.m. - 4:15 p.m.

Lunch (included ó must produce lunch voucher)

Session A or B: Joellen Killion or Lannie Kanevsky

CONFERENCE

Thursday, October 13, 2011

6:00 p.m. - 9:00 p.m.

Conference Registration

8:00 p.m. - 10:00 p.m.

Opening Greetings & Special Education Council Award Presentation

Keynote Address: David Chalk

"Possibility for All: Learning Disabilities"

10:00 p.m. - 11:30 p.m.

Wine and Cheese Reception

(2 free drink tickets are provided in your delegate package)

Friday, October 14, 2011

7:30 a.m. - 8:30 a.m.

Conference Registration

8:00 a.m. - 10:00 a.m.

PEC Greetings & Special Education Council Award Presentation

Keynote Address: Danny Brassell

"Dare to Differentiate"

10:00 a.m. - 10:30 a.m.

Refreshment Break

10:30 a.m. - 12:00 p.m.

SESSIONS

12:00 p.m. - 1:30 p.m.

Lunch (included ó must produce boxed lunch voucher)

12:15 p.m. - 1:15 p.m.

LUNCH & LEARN SESSIONS

1:30 p.m. - 3:00 p.m.

SESSIONS

3:00 p.m. - 3:30 p.m.

Refreshment Break

3:30 p.m. - 5:00 p.m.

SESSIONS

5:30 p.m. - 7:00 p.m.

Supper - Fireweed Grill/Rockies

5:30 p.m. - 7:00 p.m.

Supper - Mount Kidd Manor

7:00 p.m. - 8:30 p.m.

Supper - Olympic Ballroom

7:00 p.m. - 8:30 p.m.

Supper - Explorer Room

9:00 p.m. - 1:00 a.m.

Village People Theme Dance ó Olympic Ballroom

"Fun in the Front Seat" Band

Saturday, October 15, 2011

8:00 a.m. - 9:00 a.m.

SEC Annual General Meeting in the Bighorn Lounge

9:00 a.m. - 10:30 a.m.

SESSIONS

10:30 a.m. - 11:00 a.m.

Refreshment Break

11:00 a.m. - 12:30 p.m.

Closing Keynote: Troy Payne

"Building in Resiliency"



SOCIAL ACTIVITIES

THURSDAY, OCTOBER 13, 2011

LOCATION

10:00 p.m. ó 11:30 p.m. WINE AND CHEESE RECEPTION MAIN CONFERENCE AREA
 (Two free wine or beer tickets are included in your delegate name tag)

FRIDAY, OCTOBER 14, 2011

LOCATION

5:30 p.m. - 7:00 p.m.	SUPPER - FIRST SEATING	ROCKIES / FIREWEED GRILL
6:30 p.m. - 8:00 p.m.	SUPPER - SECOND SEATING	MOUNT KIDD BALLROOM
7:00 p.m. - 8:30 p.m.	SUPPER - THIRD SEATING	OLYMPIC BALLROOM / EXPLORER

For Delta Lodge at Kananaskis guests, some meals are included as part of your hotel costs, choose the 5:30 p.m. or 7:00 p.m. supper seating when you check in. On Friday, a bagged lunch is provided for ALL conference delegates, and may be picked up at various locations around the hotel. There will be a limited amount of Friday evening supper tickets available for guests staying at other hotels for the approximate price of \$55.00.

9:00 p.m. - 1:00 a.m. **“IT TAKES A VILLAGE”** VILLAGE PEOPLE DANCE OLYMPIC BALLROOM
 Band: *“FUN IN THE FRONT SEAT”*
 Come dressed as you favourite Village People Character!

NEW THIS YEAR: Exhibitor Passport

Visit the Exhibits in the Mount Allan Room, Mount Kidd Manor Foyer & Breezeway and get your passport endorsed from the different exhibitors to enter the draw for great prizes. See the complete list of exhibitors at the end of the program.

Responsibility of Professional Teachers

This conference, planned by the Special Education Council of the Alberta Teachers' Association, provides an excellent means of professional development specific to teaching students with special needs. By virtue of your registration at this conference, all members of the ATA have a legal obligation to attend sessions. School boards have the right to deduct salary from teachers who are absent from the conference without legitimate reasons. Further, failure to attend conference sessions may result in an investigation of unprofessional conduct under the Discipline Bylaws of the ATA. It is hoped that your attendance at sessions provides you opportunities to be informed and knowledgeable about how best to meet the special needs of all our students.

THURSDAY, OCTOBER 13, 2011 PRE-CONFERENCE

7:30 a.m. – 9:00 a.m. Pre-Conference Registration

8:30 a.m. - 11:45 a.m. KEYNOTE SPEAKERS

**SESSION A: Learning Coaches @ Work: Structuring Coaching for Effectiveness
- co-sponsored by Alberta Regional Consortia**

The introduction of learning coaches requires thoughtful planning and support for coaches, teachers, and principals. In this session learning coaches, principals, and district staff will learn about the components essential to the success of a coaching program and how to implement these components. Together they will explore various ways to structure the work of learning coaches within schools to support teacher and student learning. The session includes both large and small group discussions, presentation, case study, and problem solving designed to identify and address challenges related to having learning coaches in schools and to provide practical strategies to support coaching programs.

Outcomes:

- Identify the critical components of successful coaching programs and strategies for implementing them.
- Understand the criteria for structuring learning coaches' work.
- Generate multiple strategies to address common challenges related to coaching.
- Clarify the role of district staff, school administrators, coaches, and teachers in a successful coaching program.

Joellen Killion is a senior advisor with Learning Forward. She has been closely involved in developing coaching programs for eight years and served as a coach for teachers and principals. She is the author of numerous articles and several books on professional development and coaching including Taking the Lead: New Roles for Teachers and School-Based Coaches and has a new book on coaching scheduled for publication in the fall of 2011. She has extensive experience in supporting schools and school systems to ensure that all educators are engaged in effective professional learning to increase student success.

SESSION B: DIFFERENTIATING DIFFERENTIATED CURRICULUM

If differentiated curriculum is good for all students, what distinguishes curriculum for highly able learners? Answering this question will take us beyond the principles of differentiation, into practical tools and strategies for:

- Selecting differentiation strategies matched to the needs of individual and group of high ability students
- Finding, adapting, modifying and designing curriculum for students who need more challenge, complexity, or a faster pace in their learning.

We'll work with a few differentiation strategies and wrestle with a number of issues including assessment, management and fairness. This will be a minds-on, hands-on experience.

Lannie Kanevsky, Ph.D., is an Associate Professor of Education at Simon Fraser University. She completed her doctorate in gifted education at Teachers College, Columbia University. She teaches children whenever possible between lecturing at the University, her research, writing on differentiating learning experiences, and developing her website (www.possibilitiesforlearning.com) which offers resources to battle the boredom experienced by many highly able learners.

11:45 a.m. - 1:00 p.m.

Lunch

1:00 p.m. - 4:00 p.m.

Session A or B

CONFERENCE 2011 PROGRAM AT A GLANCE
FRIDAY, OCTOBER 14, 2011

8:00 – 10:00 a.m. Opening Greetings & Keynote Address:
Danny Brassell “Weapons of Mass Instruction: A Baker’s Dozen of Lessons Learned from the Teaching Trenches”

10:30 – 12:00 noon

FOYER	GOLD	SILVER	BRONZE	SINCLAIR	PALLISER	DAWSON	STEWART	POCATERRA
Check the Announcement Board at the Registration Area	Toby Karten Inclusion: Lesson Plan Designs	David Chalk Possibility for All: Learning Disabilities	Joellen Killion Learning Coaches @ Work: Structuring Coaching for Effectiveness	Joni Turville 10 Ways to Implement Differentiated Instruction School Wide	Leena Mahmoodi Refugee Child Enhanced Integration Project: Successful Model of Resettlement and Integration Services	Ross Ehalt What’s New in Boardmaker Using Visuals to Engage All Learners	Chris Gilham and Rennae Kletzel Mindfulness Activities for Children	Jennifer Wallace Got a Few Minutes? Implement Meaningful Daily Physical Activity

CHAMPION	WALKER	NAKISKA	MOUNT KIDD BALLROOM A	MOUNT KIDD BALLROOM B	MOUNT KIDD BALLROOM C	MOUNT ALLAN
Alberta Education Coaching	Sally Frazer and Christine Chappel Meeting Diverse needs through Inquiry Based Learning	Janice Northcott Social Skills for Children and Youth with Visual Impairments	Dr. Brian Shustak and April Byers Marital Messes ó Impact on Children	Dr. Lannie Kanevsky Buying Time for Personal Projects	Dawn Reithaug Three Tiers of Positive Support and Intervention for Behaviour (Part 1 of 3)	DISPLAYS

LUNCH SESSIONS

Dawson Room - Dr. Charlene Barva & Dr. R. Coranne Johnson: Getting Schooled in School Psychology
Palliser Room - Alex Cook & Chris Gilham: Mindfulness
Sinclair Room - Alberta Education: Action on Inclusion Update

Pick up your boxed lunch from outside the Grappa Room and bring it to the room for the session that runs from 12:15 to 1:15

FRIDAY, OCTOBER 14, 2011

1:30 – 3:00 p.m.

FOYER	GOLD	SILVER	BRONZE	SINCLAIR	PALLISER	DAWSON	STEWART	POCATERRA
Check the Announcement Board at the Registration Area	Toby Karten Inclusion: Coaching (Part 1 of 2)	Franny McAleer Differentiating Instruction with Six Thinking Hats® (Part 1 of 2)	Danny Brassell Dare to Differentiate	Kim Tackaberry Precision Reading (Part 1 of 2)	Judy Craig & Michelle Pentyluk Catching Children Before They Fail Screening Program	Dr. Paulene Kamps Developmental Coordination Disorder: A Forgotten DSM-IV Condition (Part 1 of 2)	Kathy Howery Making Connections ó UDL, ATL, DI, Personalized Learning in the Inclusive 21 st Century Classroom (Part 1 of 2)	Rob McGarva The Times are a Changing ó Teacher Assistant Professional Development

CHAMPION	WALKER	NAKISKA	MOUNT KIDD BALLROOM A	MOUNT KIDD BALLROOM B	MOUNT KIDD BALLROOM C	MOUNT ALLAN
Alberta Education Inclusion	Dr. Donsky & Darryl Weir Mindfulness at work in the Classroom	Dr. Charlene Barva & Laurie Alisat Nit-picking, Hair-splitting & Fretfulness ó Gifted Learners	Alex Dunn Smart Inclusion: Mainstream and Assistive Technology Improve Learning Outcomes for ALL Students (Part 1 of 2)	Chief Clarence Louie FNMI Leadership: óWhen The Going Gets Toughó (Part 1 of 2)	Dawn Reithaug Three Tiers of Positive Support and Intervention for Behavior (Part 2 of 3)	DISPLAYS

FRIDAY, OCTOBER 14, 2011

3:30 – 5:00 p.m.

GOLD	SILVER	BRONZE	SINCLAIR	PALLISER	DAWSON	STEWART	POCATERRA
Toby Karten Inclusion: Coaching (Part 2 of 2)	Franny McAleer Differentiating Instruction with Six Thinking Hats® (Part 2 of 2)	Danny Brassell Increasing ESL students Language & Literacy Aptitudes & Attitudes	Kim Tackaberry Precision Reading (Part 2 of 2)	Mary Catherine Bailey McKenna Best Practice with Learners with Refugee Backgrounds	Dr. Paulene Kamps Developmental Coordination Disorder: A Forgotten DSM_IV Condition (Part 2 of 2)	Kathy Howery Making Connections ó UDL, ATL, DI, Personalized Learning in the Inclusive 21 st Century Classroom (Part 2 of 2)	Pam Dymont Functional Behavior Assessment Informed Interventions

CHAMPION	WALKER	NAKISKA	MOUNT KIDD BALLROOM A	MOUNT KIDD BALLROOM B	MOUNT KIDD BALLROOM C	MOUNT ALLAN
Alberta Education Assistive Technology Practices that Make a Difference	Dr. Donsky & Darryl Weir Mindfulness at Work in the Classroom (Repeat of the 1:30 session)	Dr. Charlene Barva & Laurie Alisat Up, Down and all around, or twice exceptional, gifted students	Alex Dunn Smart Inclusion: Mainstream and Assistive Technology Improve Learning Outcomes for ALL Students (Part 2 of 2)	Chief Clarence Louie FNMI Leadership: óWhen the Going Gets Toughó (Part 2 of 2)	Dawn Reithaug Three Tiers of Positive Support and Intervention for Behavior (Part 3 of 3)	DISPLAYS

Saturday, October 15, 2011

8:00 – 9:00 a.m. Bighorn Lounge

SEC Annual General Meeting

9:00 – 10:30 a.m.

GOLD	SILVER	BRONZE	SINCLAIR	PALLISER	DAWSON	STEWART	POCATERRA
Suzanne Zwarych Student Attachment to School (FNMI perspective)	Kathy Howery What is the Experience of Talking With a Machine	Franny McAleer Differentiating Instruction: Teaching Gifted and Talented Students	Liz Spittal & Christine McCuaig Beyond the Typical Tool: Mobile Technologies for Diverse Learners (Refugee students)	Karen Bain Strategic Teaching: Complex Educational Needs	Danny Burrell Things I Wish I Knew When I Started	Sean Grainger EduKARE: A Paradigm of Hope for All Students	Mike Dreimanis Students with Severe / Profound Cognitive Delays

CHAMPION	WALKER	NAKISKA	MOUNT KIDD BALLROOM A Mount Kidd Manor	MOUNT KIDD BALLROOM B Mount Kidd Manor	MOUNT KIDD BALLROOM C Mount Kidd Manor	MOUNT ALLAN Mount Kidd Manor
Lori Fankhanel Journey Through Jordan	Kim Tackaberry GLOW (Girls Leading Others Wisely)	Myles Himmereich & Matt Bolt Foundations to Successful Environments for Youth with FASD	Alex Dunn iPads as Part of the Universal Design for Learning Toolkit	Sue Helland and Tara Macdonald Tools and Strategies for the Inclusive Classroom	Kathryn Burke A Different Point of View Through the Eyes of a Parent	DISPLAYS

11:00 a.m. – 12:30 p.m. Closing Keynote Address:

TROY PAYNE “BUILDING IN RESILIENCY”

Visit the DISPLAYS at MOUNT ALLAN ROOM, LOBBY
& MOUNT KIDD MANOR BREEZEWAY – Don’t forget your passport!
Open Times

Thursday 6:00 p.m. to 8:00 p.m.
Friday 8:00 a.m. to 6:00 p.m.
Saturday 8:00 a.m. to 1:00 p.m.

PLEASE NOTE

ROOM OVERCROWDING/FIRE CODES

The Special Education Conference attempts to honor the room size request suggested by presenters. We also try to schedule popular topics in rooms large enough to accommodate the potential audience. Please note that there are approximately 14 sessions convening at any given time during the conference and there is room for all delegates. Please select alternative sessions in advance so that you can move quickly to another session if you are unable to arrive early enough to get a seat for your first choice. For your safety and because of fire regulations, session rooms that have been filled to capacity will be restricted thereafter.

Children are not allowed in any of the sessions or social events.

Visit the DISPLAYS at
MOUNT ALLAN ROOM, MOUNT KIDD LOBBY AND MOUNT
KIDD BREEZEWAY

Open Times

Thursday	6:00 p.m. to 8:00 p.m.
Friday	8:00 a.m. to 6:00 p.m.
Saturday	8:00 a.m. to 1:00 p.m.

Don't forget to get your passport verified by the staff at the exhibits and enter your passport to win fabulous prizes.

CONFERENCE

THURSDAY, OCTOBER 13, 2011

LOCATION

6:00 p.m. - 9:00 p.m.	Conference Registration	Foyer
8:00 p.m. ó 8:30 p.m.	Opening Greetings	Olympic Ballroom
8:30 p.m. ó 10:00 p.m.	Keynote Speaker	Olympic Ballroom

David Chalk **Possibility for All: Learning Disabilities**

David Chalk was born with an undiagnosed, extreme cognitive brain condition. He struggled to learn in the same way that others conventionally did at school, but he could not. He was told to prepare for minimal success

but that's not what David had in mind. Driven by purpose to resolve who he was, David became a master of his own devices - and exposed the power of attitude, integrity and empathy. In addition, he discovered that finding purpose gives you the ability to achieve your goals. He was always interested in the advancing new world, there would be a huge obstacle blocking his path. This obstacle was a severe learning disability due to the lack of cognitive functions of his left brain. As a child, Chalk was told that learning new things would be near impossible. His story will leave you shocked and inspired. When computers began to enter the mainstream market, he knew technology would be a powerful learning tool and he seized the opportunity to use computers as a means to unlock his potential.

David Chalk is not only a success ó but also an inspiration. Hear the Incredible Story!

David Chalk is one of Canada's youngest commercial pilots, founder of Doppler Computer Superstores and founder of eLearning company Chalk Media. He has been awarded 'Retailer of Canada'. His show, "Chalk's Computer Show," has been ranked by TV Guide as 'One of 50 Best Shows on TV'. He has done keynote presentations for numerous Fortune 500 organizations and was awarded a Doctorate Degree in Technology in 2006.

PLEASE NOTE THE DOOR WILL BE CLOSED ONCE THE SPEAKER STARTS

10:00 p.m. - 11:30 p.m.	Wine and Cheese Reception	Olympic Ballroom
-------------------------	---------------------------	------------------

(Two free wine or beer tickets are in your delegate package)



CONFERENCE

FRIDAY, OCTOBER 14, 2011

LOCATION

7:30 a.m. - 9:00 a.m.	Conference Registration	Foyer
8:00 a.m. - 8:30 a.m.	PEC Greetings & Special Education Council Award Presentation	Olympic Ballroom
8:30 a.m. - 10:00 a.m.	Keynote Address	Olympic Ballroom

Danny Brassell

Weapons of Mass Instruction: A Baker’s Dozen of Lessons Learned from the Teaching Trenches

It takes a special person to be a teacher. Every day presents new challenges, and our attitudes and expectations shape our success. Join Danny as he shares a fast-paced, humorous and motivational keynote designed to show you how you make a difference in the lives of your students. From teaching preschoolers to rocket scientists, Danny shares his own trials and tribulations in the classroom as well as why he loves to teach. You’ll learn his secret to good teaching and leave feeling invigorated.

Danny Brassell is a Professor in the Teacher Education Department at California State University-Dominguez Hills. He is an experienced classroom teacher who has worked with students ranging from preschoolers to rocket scientists, and he has published numerous articles and books. His latest book is Dare to Differentiate, Third Edition: Vocabulary Strategies for All Students (Teaching Practices That Work).

10:00 a.m. - 10:30 a.m.	Refreshment Break	
10:30 a.m. - 12:00 p.m.	SESSIONS	
12:00 p.m. - 1:30 p.m.	Lunch – (Remember your boxed lunch voucher)	
12:15 p.m. - 1:15 p.m.	LUNCH SESSIONS (Dawson, Palliser & Sinclair Rooms)	
1:30 p.m. - 3:00 p.m.	SESSIONS	
3:00 p.m. - 3:30 p.m.	Refreshment Break	
3:30 p.m. - 5:00 p.m.	SESSIONS	
5:30 p.m. - 7:00 p.m.	Supper	Rockies / Fireweed Grill
6:30 p.m. - 8:00 p.m.	Supper	Mount Kidd Manor
7:00 p.m. - 8:30 p.m.	Supper	Olympic Ballroom / Explorer
9:00 p.m. - 1:00 a.m.	It Takes a Village VILLAGE PEOPLE themed Dance	Olympic Ballroom
	•Fun in the Front Seat• Band	

Come dressed as your favorite “Village People” character

For Delta Lodge at Kananaskis guests, some meals are included as part of your hotel costs, choose the 5:30 p.m. or 7:00 p.m. supper seating when you check in. On Friday, a bagged lunch is provided for ALL conference delegates, and may be picked up at various locations around the hotel. There will be a limited amount of Friday evening supper tickets available for guests staying at other hotels for the approximate price of \$55.

CONFERENCE
SATURDAY, OCTOBER 15, 2011

8:00 a.m. - 9:00 a.m.	SEC Annual General Meeting (Bighorn Lounge)
9:00 a.m. - 10:30 a.m.	SESSIONS
10:30 a.m. - 11:00 a.m.	Refreshment Break
11:00 a.m. - 12:30 p.m.	Closing Keynote Address:

Troy Payne
Building in Resiliency

Children today are confronted with many adversities that can impact their personal wellness and influence the adults they become. These challenges can change a child's life forever – so can overcoming them. It is a pivotal and beautiful moment in a child's life when they connect with an adult and feel that someone really –sees– them for the first time. What can we do as parents, counsellors, educators, and members of our community to ensure that our children lead healthy, harmonious lives? How can we best support our children towards seeing their true potential? Using the combined power of storytelling and music, "Building in Resiliency" pays homage to those in the helping profession. It demonstrates the power each of us has to make a difference in the lives of others and celebrates this opportunity. Troy's message brings inspiration into fruition for all those who are bright lights in the lives of children.

Troy Payne is an inspirational speaker who took the cards life dealt him and turned them into opportunities to positively impact the lives of children and those who work alongside them. Troy attributes his personal growth to the support of great educators, counsellors, and enriching school programs that opened his eyes to his true potential. Following post-secondary education, Troy became a Child & Youth Care Worker, working in schools and residential treatment centres, counselling youth and their families. Inspired to reach more people, Troy started his company Wellness Realization and since then has connected with over 100,000 people through his presentations.

REMINDERS

-  **Check out time for the Delta Lodge and Mount Kidd Manor is 11:00 a.m.**
 - **Video checkout is available**
 - **Luggage can be stored until you are ready to leave**

-  **Special Education Conference 2012 will be held in Kananaskis on October 11-13, 2012**

CONFERENCE SESSION DESCRIPTIONS

FRIDAY, OCTOBER 14, 2011

LOCATION

10:30 – 12:00 noon

Inclusion: Lesson Plan Designs	Gold
---------------------------------------	-------------

Supporting the Learner

Knowledge, research, technology and attitudes toward people with disabilities have progressed from outdated exclusive policies and lower student expectations to inclusive policies with the expectation and planning of higher outcomes for students of all abilities. Educational achievements for students with disabilities require administrative support and solid lesson planning that proactively expects, accepts, and embraces differences. Experience how to effectively:

- Plan daily, weekly, monthly, quarterly, and annual objectives
- Highlight the materials, goals, procedures, strategies, steps, and curriculum-based assessments
- Document IEPs, 504s and RTI
- Examine differentiated instruction for whole class, small groups, and individual students
- Provide on-line information to co-teachers, principals, data coordinators, student support teams, supervisors and coaches
- Accomplish effective co-teaching partnerships

Toby J. Karten, Adjunct professor with The College of New Jersey, Drew University, Gratz College, and Washington College

Possibility for All: Learning Disabilities	Silver
---	---------------

Exceptional Needs

David's commitment to education and effective e-learning is rooted in his life experience of he overcame a severe learning disability to become an expert guide in the digital world. Today, Chalk helps others tap into their abilities, using technology as a vehicle to do so. He explores the real possibilities of the human mind and shows how technology can help students be more successful.

David Chalk is the founder of Doppler Computer Superstores and eLearning company Chalk Media. He has been awarded „Retailer of Canada “. He has done keynote presentations for numerous Fortune 500 organizations and was awarded a Doctorate Degree in Technology in 2006.

Learning Coaches @ Work: Structuring Coaching for Effectiveness	Bronze
--	---------------

Supporting the Learner

The introduction of learning coaches requires thoughtful planning and support for coaches, teachers, and principals. In this session learning coaches, principals, and district staff will learn about the components essential to the success of a coaching program and how to implement these components. Together they will explore various ways to structure the work of learning coaches within schools to support teacher and student learning.

Joellen Killion is a senior advisor with Learning Forward. She has been closely involved in developing coaching programs for eight years and served as a coach for teachers and principals. She is the author of numerous articles and several books on professional development and coaching including Taking the Lead: New Roles for Teachers and School-Based Coaches and has a new book on coaching scheduled for publication in the fall of 2011.

Visit the DISPLAYS in the MOUNT KIDD MANOR

Open Times

Thursday	6:00 p.m. to 8:00 p.m.
Friday	8:00 a.m. to 6:00 p.m.
Saturday	8:00 a.m. to 1:00 p.m.

CONFERENCE

10:30 a.m. – 12:00 noon

FRIDAY, OCTOBER 15, 2010

LOCATION

10 Ways to Implement Differentiated Instruction School Wide
--

Sinclair

Supporting the Learner

Implementing school and district-wide differentiated instruction plans can be a challenge. As a result, knowing some of the dos and don'ts can be helpful. The facilitator will share real-world experiences while helping facilitate a district-wide differentiated instruction program.

Joni Turville, Executive Staff Officer, Professional Development, Alberta Teachers' Association and advisor to the provincial Special Education Council

Refugee Child Enhanced Integration Project

Palliser

Diversity and Culture

This session includes an overview of the challenges that refugee children and youth face when they enter their host country. In addition, the session will also introduce best practices, undertaken by Refugee Child Enhanced Integration Project of CCIS which has effectively supported refugee children and youth with their integration in their new society.

Leena Mahmoodi, Coordinator of Enhanced Child, Enhanced Integration Project, Calgary Catholic Immigration Society

Using Visuals to Engage All Learners

Dawson

Technology

Visual supports can be a powerful tool within an educational environment. They can be used to support organization and routines, positive behaviour, social interaction and communication as well as academics. Participants to this session will be introduced to a wide variety of visual support tools and ways of using them within an educational environment. Several examples of software commonly used to create visual supports (Boardmaker, Symwriter, Communicate In Print, etc.) will be discussed.

Session Objectives:

- Gain an understanding of the value of visual supports within the educational environment.
- Be provided with a range of ideas and resources that may help to inspire and encourage further use of symbols in the classroom.
- Learn about current ATL products used to create visual supports.

Ross Ehalt, Occupational Therapist and Assistive Technology for Learning Consultant with Edmonton Regional Educational Consulting Service

Mindfulness Activities for Children
--

Stewart

Mental Health and Behavior

Join us as we share, demonstrate and show mindfulness related activities that can be used across any setting. Participants will also leave the workshop with mindfulness "tools" at hand, ready for classrooms and homes!

*Chris Gilham, Social, Emotional, Mental Health, Behavioral Strategist, Calgary Board of Education
Rennae Kletzel Gilham, Family Support Liaison, PREP Program, Calgary, Alberta*



CONFERENCE

10:30 a.m. – 12:00 noon

FRIDAY, OCTOBER 14, 2011

LOCATION

Got A Few Minutes? Implement Meaning Daily Physical Activity

Pocaterra

Mental Health and Behavior

Do you want to incorporate daily physical activities that involve curricular outcomes? Are you looking for more physical activity opportunities for your students that foster cooperation and social skills? If so, then this is the workshop for you! This session will include activity ideas for the classroom, gymnasium, multipurpose room and outdoors taken from two Ever Active Schools resources: Recipe Card Lesson Plans & DPA Bins.

Jennifer Wallace, teaches Physical Education and Science in Calgary, has successfully adapted her programs to include each child, shares her passion for physical activity with her students, recipient this year of the Physical Education Teaching Excellence Award from PHE Canada.

Alberta Education: Coaching

Champion

Alberta Education

Meeting Diverse needs through Inquiry Based Learning

Walker

Supporting the Learner

We will present a simple 3 step model that can be used across the curriculum. You will participate in a hands-on practical inquiry that will give you the fundamentals to use this approach in your classroom. We will provide examples of student engagement and how students with diverse needs can access the curriculum through inquiry based learning. We will provide examples of how inquiry based learning fits with differentiated instruction. Learn how to make subtle shifts in your existing activities to help your students strengthen their process skills needed for inquiry based learning. Inquiry is a powerful means of learning. Inquiry has a structure with distinct phases. In doing inquiry, learners can take many different paths to learn the same content.

*Sally Frazer, Curriculum Leader for Language Arts, IEPT Pilot Coordinator, Red Deer Public School District
Christine Chappell, High School Science teacher, Science Curriculum Leader, Red Deer Public School District*

Social Skills for Children and Youth with Visual Impairments

Nakiska

Exceptional Needs

The development of social interaction skills begins in infancy. For the sighted, these skills are learned naturally and easily, simply by visually observing other people and behaving in socially appropriate ways based on that information. These skills are learned incidentally through interactions with family members and peers. Blind or visually impaired children can have a difficult time developing social skills. They do not have the benefit of visual cues that sighted children have such as facial expressions and body language.

This session will help individuals understand the potential impact that a visual impairment has on the student's ability to access the social environment at school and to offer suggestions and strategies for teaching / fostering the development of social skills.

Janice Northcott, Learning Specialist - Vision for Calgary Board of Education

Visit the DISPLAYS in the MOUNT KIDD MANOR

Thursday	6:00 p.m. to 8:00 p.m.
Friday	8:00 a.m. to 6:00 p.m.
Saturday	8:00 a.m. to 1:00 p.m.

CONFERENCE

10:30 a.m. – 12:00 noon

FRIDAY, OCTOBER 14, 2011

LOCATION

Marital Messes – Impact on Children

**Mount Kidd Ballroom A
Mount Kidd Manor**

Mental Health and Behavior

Children living through their parent's marital and related emotional messes do not typically experience a smooth go of it. They can be impacted on a number of levels, most of which can show up in the classroom. Lest a teacher suspect they are dealing with an inattentive or aggressive child (and respond only to the behaviours), better to have an appreciation of underlying environments, and organize appropriate supports.

*Dr. Brian Shustack, Psychologist, Calgary Board of Education, Expert Witness in cases involving High Risk Children
April Byers, Psychologist, Calgary Board of Education*

Buying Time for Personal Projects

**Mount Kidd Ballroom B
Mount Kidd Manor**

Supporting the Learner

Curriculum compacting is an evidence-based process for reducing the time highly able learners spend on unnecessary review and practice when they are ready to move beyond grade-level expectations. They can earn time to pursue their interests when given opportunities to demonstrate their mastery in pre-assessments (formal and informal). We'll explore pre-assessment strategies that identify material already mastered, streamlining techniques for reducing or eliminating material students don't need to re-learn, and options for manageable replacement activities that enable students to forge ahead into challenging authentic learning. A survey, the *Possibilities for Learning*, will be introduced as a tool for identifying student learning preferences in their area(s) of passion. Students and teachers can use the survey results to develop engaging, personal projects and contracts that make terrific replacement activities after the curriculum has been compacted.

Lannie Kanevsky, Ph.D., is an Associate Professor of Education at Simon Fraser University. She completed her doctorate in gifted education at Teachers College, Columbia University.

Three Tiers of Positive Support and Intervention for Behavior Part 1 of 3

**Mount Kidd Ballroom C
Mount Kidd Manor**

Mental Health and Behaviour

This session is based on the *Response to Intervention* literature and summarizes a three-tiered system of assessments, positive supports, and interventions that educators can consider when focusing on, and building capacity for, improving behavioural outcomes in their schools.

Positive supports and/or interventions can help meet the behavioural needs for each student:

Tier 1: School-wide and classroom-wide supports for ALL students.

Tier 2: Targeted group or individualized interventions for 5% to 15% of students.

Tier 3: Intensive, individualized intervention for 1% to 5% of students.

You will also explore appropriate assessments (screening and both direct and indirect progress monitoring assessments) aligned to the tiers, and will practise using some of these.

Dawn Reithaug, M.Ed., Educational and behavioural consultant and author. Vancouver, B.C.

Co-sponsored by the Alberta Regional Consortia



CONFERENCE

12:15 p.m. – 1:15 p.m.

FRIDAY, OCTOBER 14, 2011

LOCATION

Getting Schooled in School Psychology: Educators & Psychologists Working Together	Dawson
--	---------------

Who is the 21st century school psychologist? What assistance can a school psychologist provide to teachers who are educating students with diverse learning needs? The student population entering today's classrooms is more challenging than ever. It is important that teachers are cognizant of the array of skills of a school psychologist. The goal of this session is to empower educators on how to utilize the expertise of school psychologists when developing and implementing programming for children with exceptional needs.

Dr. Charlene Barva, Psychologist, CBE. PhD in Applied Psychology. Representative of Gifted and Talented Learners with the Special Education Council

Dr. R. Coranne Johnson, Psychologist in private practice

Sneaking Through the System with Mental Health Challenges: A Student's Perspective	Palliser
---	-----------------

Every student has unique challenges as they work their way through the education system on their journey to become valuable members of society. These challenges are seemingly as trivial as trying to get a girl away from her pack of friends for that first intimate conversation, or as serious as dealing with potentially deadly mental health issues. I have suffered from both of these afflictions. Join us as we share their story of the battle with mental health in pursuit of an education. Followed by questions and a discussion period on the topic.

Alexander C. Cook BSc. MEng, MBA, CAPM, works for Penn West

Chris Gilham, Social, Emotional, Behavioural, Mental Health Strategist, Calgary Board of Education

Alberta Education: Action on Inclusion Update	Sinclair
--	-----------------

In June 2010, the Government of Alberta provided its formal response to the *Setting the Direction* framework in which it accepted all 12 of the recommendations, which the response identified as strategic directions for it to implement. In the fall of 2010, inclusion was identified as part of government's Inspiring Action on Education initiative, and *Setting the Direction* was renamed *Action on Inclusion* to signal implementation of an inclusive education system

Alberta Education

CONFERENCE

1:30 p.m. – 3:00 p.m.

FRIDAY, OCTOBER 14, 2011

LOCATION

Inclusion: Coaching: Strategies, Interventions, Collaborations and Support Part 1 of 2	Gold
---	-------------

Supporting the Learner

This session increases sensitivities about everyone's abilities with inclusion preparation with educators, families, support staff, students, peers, communities, and all organizations. Resources and knowledge about differing cognitive, emotional, social, behavioural, developmental, sensory, physical, and communication skills will be outlined and shared with literature, movies, books, and appropriate inclusion strategies and awareness activities. The ultimate goal is to continually cultivate an inclusive environment that yields productive lives for individuals of all abilities.

Toby J. Karten, Adjunct professor with The College of New Jersey, Drew University, Gratz College, and Washington College

CONFERENCE

1:30 p.m. – 3:00 p.m.

FRIDAY, OCTOBER 14, 2011

LOCATION

Differentiating Instruction with Six Thinking Hats® Part 1 of 2	Silver
--	---------------

Supporting the Learner

SIX HATS® is a simple and powerful way to differentiate the questioning process and teach thinking as an skill that can be learned, practiced, and improved. The SIX HATS® promote differentiated learning by teaching students to think at higher levels and improve writing, reading, and speaking skills. The colors and hats provide a useful visual image that is easy to learn and remember. The game and role-playing nature of the hats compliment how the brain works. So, put on the SIX THINKING HATS® and improve thinking, questioning, and communication.

Franny McAleer, Past-President of the Pennsylvania Association for Gifted Education, teaches gifted education graduate classes at Duquesne University

Dare to Differentiate	Bronze
------------------------------	---------------

Supporting the Learner

Reinvigorate your passion for teaching! Danny reveals 50 terrific tricks successful teachers have used to stimulate students' interest in learning. You'll leave this session with new songs, games, and activities you can immediately put to use in your classroom!

Danny Brassell, Professor in the Teacher Education Department at California State University-Dominguez Hills

Precision Reading Part 1 of 2	Sinclair
--	-----------------

Supporting the Learner

Precision Reading is a short, daily, research-based remedial reading activity designed to improve fluency, sight word vocabulary, and passage comprehension. Five components will be taught during the session: core strategy, formatting procedures, support strategies, complimentary strategies and comprehension. Research related to pre-school exposure to books and the importance of automaticity in reading are discussed and linked to the program's success in building student's self-esteem. The workshop is hands-on as well as interactive. Time is allotted for participants to practice the core strategy. This Canadian program was created by Dr. Rick Freeze, professor at the University of Manitoba.

Kim Tackaberry B.A, B. Ed., Specialist in Special Education, Foothills Academy, Calgary, AB.

Catching Children Before They Fail: Implementing a Classroom Based Screening Program for Reading Disabilities	Palliser
--	-----------------

Exceptional Needs

With a goal that all children in Alberta in Kindergarten and Grade 1 should be screened for potential reading difficulties, the Learning Disabilities Association of Alberta (LDAA) assembled an expert panel to create the Reading Readiness Screening Tool (RRST). Designed for administration by teachers in their classrooms, preliminary indications are that the RRST is a pragmatic, effective and economic tool to support identification of students at risk for reading problems due to both neurological and environmental issues. The RRST is accompanied by a teacher training video and suite of training material. Speakers will provide an overview of the RRST and its uses and how universal screening is a necessary first stage of the identification/assessment process for reading disabilities.

Judy Craig, M.Ed. retired administrator with Edmonton Public Schools, President of the Learning Disabilities Association of Alberta

Michele Pentyluk, Registered Psychologist, Past President of the Learning Disabilities Association of Alberta

CONFERENCE

1:30 p.m. – 3:00 p.m.

FRIDAY, OCTOBER 14, 2011

LOCATION

**Development Coordination Disorder: A Forgotten DSM-IV Condition
Part 1 of 2**

Dawson

Exceptional Needs

Developmental Coordination Disorder (DCD) is a legitimate DSM-IV condition that is seldom recognized or diagnosed in North America yet it affects a student's motor skills, academic achievement, psychological well-being, and over time, their physical health as well! Be prepared to learn a lot about this topic!

Dr. Paulene Kamps, registered psychologist, teacher, and kinesiologist, Founder and Director of KAMPS (Kinesiology and Meta-cognitive Psychological Services)

**Making Connections: UDL, ATL, DI, Personalized Learning in the
Inclusive 21st Century Classroom
Part 1 of 2**

Stewart

Supporting the Learner

What are all these acronyms? UDL, ATL, DI, PL, í And what do they mean in the context of 21st Century Learning and Inclusive Education?

Using the principles of Universal Design for Learning as the foundation, participants will explore various online resources to help inform their understanding and practice. The relationship between UDL and differentiated instruction will be discussed. How can we leverage these practices to personalize learning in today's classrooms? And, when and how, do we need to go beyond UDL and look to assistive technologies to ensure access and meaningful participation for every learner? The session will present research from Alberta, from the UDL Implementation Network and from published literature. Hands on exploration of websites and tools will be facilitated. Come prepared to create a recipe for you students' success.

Kathy Howery, doctoral student at UofA, Educational Consultant. Kathy has worked for close to 30 years in the area of assistive technology, special education and universal design for learning (UDL).

The Times Are A Changing: Teacher Assistant Professional Development

Pocaterra

Exceptional Needs

The skills of Teacher Assistants needs to evolve in response to shifts in educational practice, such as coping with inclusion and supporting formative assessment techniques. This interactive session will allow participants the opportunity to discuss the professional development needs of TA's and ideas for helping them develop the required Knowledge, Skills and Attitudes. The speaker will also share material to provide 5 hours of TA PD in a collaborative format.

Rob McGarva, Director of Student Services for the Pembina Hills Regional Division and associate faculty for City University of Seattle Edmonton Campus

Alberta Education: Inclusive Education – Support for Implementation

Champion

Alberta Education



CONFERENCE

1:30 p.m. – 3:00 p.m.

FRIDAY, OCTOBER 14, 2011

LOCATION

Mindfulness at Work in the Classroom	Walker
---	---------------

Mental Health and Behavior

Mindfulness (the art of being fully present in each moment of our lives, in a non judgmental and helpful way) has found its way into many areas of our society.

This workshop will start with a presentation on the history and principles of mindfulness and its application to everyday life. There will be an overview of the role of Mindfulness in Education. Given that Mindfulness is a way of being, the majority of the workshop will be experiential with participants engaging in a variety of mindful experiences including sitting, eating and walking practice. There will be much opportunity for reflection and interaction throughout. Participants do not need any previous experience with mindfulness or meditation.

Dr. Allan Donsky, Child and Adolescent Psychiatrist, Calgary, AB
Darryl Weir, Retired Mental Health Specialist, Calgary Board of Education

Nit-picking, Hair-splitting, & Fretfulness...or Perfection & Anxiety In Gifted Learners	Nakiska
--	----------------

Exceptional Needs

This will be an interactive session focusing on understanding the social and emotional needs of gifted learners and how to support them in the classroom both proactively and reactively. Case studies will be used to generate discussion around topics such as perfectionism and anxiety displayed around writing, tests, performance, and social interaction.

Dr. Charlene Barva, Psychologist, CBE. PhD in Applied Psychology. Representative of Gifted and Talented Learners with the Special Education Council
Laurie Alisat, Learning Leader, CBE. She is working on her PhD researching identified gifted boys experience in school

Smart Inclusion: Mainstream and Assistive Technology Improve Learning Outcomes for ALL Students	Part 1 of 2	Mount Kidd Ballroom A Mount Kidd Manor
--	--------------------	---

Technology

iPads, SMART Boards, SMART Table, laptops, Nintendo DSi, switches and Web 2.0 ó Teachers, Speech Language Pathologists and students at Upper Canada District School Board team up to create a new way to teach and learn which engages, supports and includes ALL students, including those with special needs. Through demonstration and videotaped examples, you will experience how a universally designed for learning toolkit including mainstream and assistive technology, traditional teaching methods, all situated within the context of UDL, DI and the Participation Model, can enhance educational and social participation for ALL students including those with disabilities; necessary for some, good for all.

Alex Dunn, Speech-Language Pathologist, Upper Canada District School Board (UCDSB), Oxford Mills, Ontario

FNMI Leadership: “When The Going Gets Tough”	Part 1 of 2	Mount Kidd Ballroom B Mount Kidd Manor
---	--------------------	---

Diversity and Culture

Chief Clarence feels that leadership requires courage, vision, and balance and that to be an effective leader these qualities must be present and able to be drawn upon when the "going gets tough". He is a lifelong student of issues affecting First Nations. "Every First Nation comes from a working culture. Our ancestors worked hard for a living. Today life is as complicated or as messed up as you make it. To improve your quality of life, you either go to school or get a job. Words without action, excuses and blame, leads towards more welfare dependency and poverty.ö

Chief Clarence Louie, Chief and CEO of the Osoyoos Band in British Columbia's South Okanagan. 1999 Aboriginal Business Leader of the Year - All Nations Development Corporation, 2000 CANDO Award for Economic Developer of the Year.

CONFERENCE

1:30 p.m. – 3:00 p.m.

FRIDAY, OCTOBER 14, 2011

LOCATION

Three Tiers of Positive Support and Intervention for Behavior Part 2 of 3	Mount Kidd Ballroom C Mount Kidd Manor
--	---

Mental Health and Behavior

This is a full day session that began at 10:30 a.m.. Please see the description in the 10:30 a.m. to 12:00 Noon section.

Dawn Reithaug, M.Ed., Educational and behavioural consultant and author. Vancouver, B.C.

Co-sponsored by the Alberta Regional Consortia



CONFERENCE

3:30 – 5:00 p.m.

FRIDAY, OCTOBER 14, 2011

LOCATION

Inclusion: Coaching Part 2 of 2	Gold
--	-------------

Gold

Supporting the Learner

This is a 3 hour session that began at 1:30 PM. Please see the description in the 1:30 to 3:00 p.m. section

Toby J. Karten, Adjunct professor with The College of New Jersey, Drew University, Gratz College, and Washington College

Differentiating Instruction with Six Thinking Hats® Part 2 of 2	Silver
--	---------------

Silver

Supporting the Learner

This is a 3 hour session that began at 1:30 PM. Please see the description in the 1:30 to 3:00 p.m. section

Franny McAleer, Past-President of the Pennsylvania Association for Gifted Education, teaches gifted education graduate classes at Duquesne University

Increasing ESL Students Language & Literacy Aptitudes & Attitudes	Bronze
--	---------------

Bronze

Diversity and Culture

Boost vocabulary. Improve reading skills. Accelerate language acquisition. Join Danny to discover helpful tips, valuable strategies and outstanding children's literature you can use to enhance the literacy skills of your English language learners. Plus, you'll explore how to promote greater cultural understanding in your classroom by building on the varied backgrounds of your students.

Danny Brassell, Professor in the Teacher Education Department at California State University-Dominguez Hills

CONFERENCE

3:30 – 5:00 p.m.

FRIDAY, OCTOBER 14, 2011

LOCATION

**Precision Reading
Part 2 of 2**

Sinclair

Supporting the Learner

This is a 3 hour session that began at 1:30 p.m. Please see the description in the 1:30 ó 3:00 p.m. section

Kim Tackaberry B.A, B. Ed., Specialist in Special Education, Foothills Academy, Calgary, AB.

**Best Practice with Learners with Refugee Backgrounds:
A Trauma Informed Perspective**

Palliser

Diversity and Culture

Alberta schools continue to face the challenges of working with students with refugee backgrounds. Shifts in immigration policy within the last decade have resulted in an increase in the complexity of these learners. In this interactive adult-education workshop you will have the opportunity to:

- deepen your understanding of the tasks faced by learners with refugee backgrounds
- review your own strengths in working with this population
- build upon strategies and insights gathered from other teachers and demonstrated by model schools
- prioritize strategies through a trauma-informed lens
- develop a òbest practiceö approach in work with these students.

Mary-Catherine Bailey-McKenna is a registered psychologist and certified teacher and internationally certified trainer. She works to synthesize current research with practical strategies. Currently working with the Calgary Board of Education, she is helping to develop a provincial web based resource for teachers working with learners with refugee backgrounds.

**Development Coordination Disorder: A Forgotten DSM-IV Condition
Part 2 of 2**

Dawson

Exceptional Needs

This is a 3 hour session that began at 1:30 p.m.. Please see the description in the 1:30 ó 3:00 p.m. section.

Dr. Paulene Kamps, registered psychologist, teacher, and kinesiologist, Founder and Director of KAMPS (Kinesiology and Meta-cognitive Psychological Services)

**Making Connections: UDL, ATL, DI, Personalized Learning in the
Inclusive 21st Century Classroom
Part 2 of 2**

Stewart

Supporting the Learner

This is a 3 hour session that began at 1:30 p.m. Please see the description in the 1:30 ó 3:00 p.m. section.

Kathy Howery, doctoral student at U of A, Educational Consultant. Kathy has worked for close to 30 years in the area of assistive technology, special education and universal design for learning (UDL).

Functional Behavior Assessment Informed Interventions

Pocaterra

Exceptional Needs

Participants will become aware of how functional assessment informs behavioural intervention. Specific interventions including: reinforcement, extinction, differential reinforcement procedures, functional communication training and antecedent interventions will be discussed in detail. Use evidence-based practice and data driven decision making to create behaviour intervention plans that are effective in solving a wide range of problem behaviours. This workshop will be of particular interest for those working with students on the autism spectrum, with cognitive delays and/or severe social/ emotional challenges.

Pam Dymont, Functional Behaviour Analyst, Calgary Board of Education

CONFERENCE

3:30 – 5:00 p.m.

FRIDAY, OCTOBER 14, 2011

LOCATION

Alberta Education: Assistive Technology – Practices that Make a Difference	Champion
---	-----------------

Alberta Education

Mindfulness at Work in the Classroom (This is a repeat of the 1:30 session)	Walker
--	---------------

Mental Health and Behavior

Mindfulness (the art of being fully present in each moment of our lives, in a non judgmental and helpful way) has found its way into many areas of our society.

This workshop will start with a presentation on the history and principles of mindfulness and its application to everyday life. There will be an overview of the role of Mindfulness in Education. Given that Mindfulness is a way of being, the majority of the workshop will be experiential with participants engaging in a variety of mindful experiences including sitting, eating and walking practice. There will be much opportunity for reflection and interaction throughout. Participants do not need any previous experience with mindfulness or meditation.

*Dr. Allan Donsky, Child and Adolescent Psychiatrist, Calgary, AB
Darryl Weir, Retired Mental Health Specialist, Calgary Board of Education*

Up, Down and All Around.... Or Twice Exceptional, Gifted Students In Your Classroom	Nakiska
--	----------------

Exceptional Needs

Gifted LD, ASD, ADHD, ELL, are among the complexities some gifted children experience. How do they exist in our classrooms and how can we provide for them to allow them to flourish? Recognizing the characteristics and needs of gifted students with multiple complexities, including Aspergers (ASD), Attention Deficit-Hyper-Activity Disorder (ADHD), Learning Disability (LD) and English Language Learners (ELL) in our classroom is only half the challenge we face as teachers. The other half is providing the learning environment to support their growth and development alongside your other students. In this very full session, we will provide an overview of the research around these complex learners and some strategies.

*Dr. Charlene Barva, Psychologist, CBE. PhD in Applied Psychology. Representative of Gifted and Talented Learners with the Special Education Council
Laurie Alisat, Learning Leader, CBE. She is working on her PhD researching identified gifted boys experience in school*

Smart Inclusion: Mainstream and Assistive Technology Improve Learning Outcomes for ALL Students	Part 2 of 2	Mount Kidd Ballroom A Mount Kidd Manor
--	--------------------	---

Technology

This is a 3 hour session that began at 1:30 p.m. Please see the description in the 1:30 to 3:00 p.m. section

Alex Dunn, Speech-Language Pathologist, Upper Canada District School Board (UCDSB), Oxford Mills, Ontario

Visit the DISPLAYS in the MOUNT KIDD MANOR

Thursday	6:00 p.m. to 8:00 p.m.
Friday	8:00 a.m. to 6:00 p.m.
Saturday	8:00 a.m. to 1:00 p.m.

CONFERENCE
3:30 – 5:00 p.m.

FRIDAY, OCTOBER 14, 2011

LOCATION

FNMI Leadership: “When The Going Gets Tough” Part 2 of 2	Mount Kidd Ballroom B Mount Kidd Manor
---	---

Diversity and Culture

This is a 3 hour session that began at 1:30 p.m. Please see the description in the 1:30 ó 3:00 p.m. section

Chief Clarence Louie, Chief and CEO of the Osoyoos Band in British Columbia's South Okanagan. 1999 Aboriginal Business Leader of the Year - All Nations Development Corporation, 2000 CANDO Award for Economic Developer of the Year

Three Tiers of Positive Support and Intervention for Behavior Part 3 of 3	Mount Kidd Ballroom C Mount Kidd Manor
--	---

Mental Health and Behavior

This is a full day session that began at 10:30 a.m. Please see the description in the 10:30 a.m. ó 12:00 Noon section.

Dawn Reithaug, M.Ed., Educational and behavioural consultant and author. Vancouver, B.C

Co-Sponsored by the Alberta Regional Consortia



CONFERENCE
SATURDAY: 8:00 a.m.

Saturday, October 15, 2011

LOCATION

Special Education Council Annual General Meeting 8:00 – 9:00 a.m.	Bighorn Lounge
--	-----------------------

Meeting

Join the Executive of the Special Education Council for our Annual General Meeting.

This **meeting** includes:

- Annual Report of the Council
- Treasurer's Report
- Complimentary continental breakfast

PRIZE: win a free registration to Celebrating the Challenges Conference 2012 to be held in Kananaskis

ATA - Special Education Council

CONFERENCE

9:00 – 10:30 a.m.

SATURDAY, OCTOBER 15, 2011

LOCATION

**Student Attachment to School: Creating Classroom and School Environments
So that All Students Can Be Successful**

Gold

Diversity and Culture

Creating a healthy learning environment is an essential precursor to learning for all students. This session sets the stage for discussions about how we structure the school, the school day, and the classroom in a way that influences a child's feelings of safety and security. Identifying student protective factors at school allows us to put supports in place that enhance school achievement and reduce risk behaviours such as victimization, poor social relations, and alienation from school. There is not a one-size-fits-all solution for increasing student attachment to school; diverse populations and student demographics report varied responses to supports such as decreased class sizes, behavioural interventions, mixed ability classrooms, teacher academic support, and student social climates. This session will examine current research in secondary schools, FNMI populations, isolated communities in Alaska, and research on youth risk behaviours and achievement results.

Suzanne Zwarych Ph. D. – Western Canada Education Coordinator for the Centre for Addiction & Mental Health at the University of Western Ontario based out of the Aboriginal Educational Research Centre at the University of Saskatchewan.

What if the Experience of Talking With A Machine

Silver

Technology

Let's talk about talking. This session will present a phenomenological research study exploring the lived experience of people who speak using speech generating communication devices (SGCDs). Today, technologies enable speech for people who are unintelligible with their natural voice - for children who are "speechless". It is technology that enables the ordinary. Something most humans take utterly for granted - the power of speech. But speech is not taken for granted by device users. Their experience of having a voice, a voice that is theirs, a voice that enables, but not quite, the ability to participate in the flow of human conversation, is different. What can we, as teacher and supporters of students who use SGCDs, learn from their lived experiences? How can their words inform practice and pedagogy in the classroom and beyond? What can we learn from this type of inquiry and why is it important that we do?

Kathy Howery, doctoral student at U of A, Educational Consultant. Kathy has worked for close to 30 years in the area of assistive technology, special education and universal design for learning (UDL).

Differentiating Instruction: Teaching Gifted and Talented Students

Bronze

Supporting the Learner

Do you have students who learn at an advanced level and accelerated pace? You can meet the needs of these learners through differentiated instruction. This workshop presents the principles and strategies to help you meet their needs.

Franny McAleer, Past-President of the Pennsylvania Association for Gifted Education, teaches gifted education graduate classes at Duquesne University

Beyond the Typical Tool: Mobile Technologies for Diverse Learners (refugee students)

Sinclair

Technology

This session will demonstrate the use of mobile technologies such as flip video cameras and iPads as tools to support English Language Learners with diverse learning needs. These tools can be used to assist in the acquisition of language and content in unique and engaging ways. An example of the real-life use of this technology and instructional benefits will be shared.

Liz Spittal-Cote and Pauline Auld work for the Calgary Board of Education as Learning Specialists, supporting diverse student populations

CONFERENCE

9:00 – 10:30 a.m.

SATURDAY, OCTOBER 15, 2011

LOCATION

Strategic Teaching: Complex Educational Needs

Palliser

Exceptional Needs

Increasing numbers of students who have complex special educational needs such as Autism Spectrum Disorders and Emotional/Behaviour Challenges are being taught and included in Alberta Schools. Many are engaged in typical classrooms, others remain in congregated sites. No matter what placement is made, these students require specialized, positive program planning based on their individual social, communication and academic needs. Research, experience, and evidence-based intervention practices indicate a number of specific components are essential to promote effective teaching and learning as well as provide positive behaviour supports. Come prepared to review these components as well as design your own pyramids of supportive strategies.

Karen Bain, Educational and Behavioural Programming Consultant with Edmonton Regional Educational Consulting Services (ERECS)

Things I Wish I Knew When I Started

Dawson

Mental Health and Behavior

An insightful, irreverent look at the full scope of working with behaviourally challenged students. Danny will offer quick tips and tricks to dealing with the students while attempting to keep our own sanity. Ninety minutes of humour and wisdom that will give participants practical strategies and points to ponder. Fast paced and positive, this session provides a pat on the back and a hand up for anyone working in a school setting.

Danny Burrell, award winning employee of Edmonton Catholic Schools

EduKARE: A Paradigm of Hope for All Students

Stewart

Mental Health and Behavior

EduKARE is an asset-based positive school reform movement designed around student's personal learning stories. EduKARE combines the best of wrap-a-round service provision in schools with a focus on making deep personal connections with students; their hopes, dreams, challenges and successes. An EduKARE approach targets incremental social, emotional and academic growth in every student adjusting for the individual developmental, social and emotional variables each one presents.

This session will explore the background to EduKARE, and in particular, the notion that applying an EduKARE philosophy in your school or classroom is a "better, faster and cheaper" way to help each student be successful in school, and in life. Participants will explore resiliency, their own and their student's, as they learn how to leverage strengths and mitigate weaknesses by thinking differently about how school is structured.

Sean Grainger, School Administrator in a thriving K-5 school in Red Deer Public School District

Students with Severe / Profound Cognitive Delays: A Meaningful Curriculum

Pocaterra

Exceptional Needs

It is difficult to decide what goals or activities are meaningful for students who have severe to profound cognitive delays or multiple disabilities. In the absence of a "packaged" curriculum, setting up individual program plans and routines can be challenging for staff. This workshop will provide a framework for:

- Selection of meaningful goals and objectives
- Using opportunities across the day to work on these goals

Participants are encouraged to bring classroom examples so that they can apply what they have learned with their students.

Mike Dreimanis, Consultant for Educational and Behavioural Programming, Edmonton Regional Educational Consulting Services, Edmonton Public School Board

CONFERENCE

9:00 – 10:30 a.m.

SATURDAY, OCTOBER 15, 2011

LOCATION

Journey Through Jordan

Champion

Exceptional Needs

Lori Fankhanel will share her journey of having two children with a disorder not yet recognized on the DSM and her experience through the school system due to this and the strategies and successes that have occurred. One of her children has challenges due to being gifted and having Sensory Processing Disorder (SPD), and another child with severe SPD and cognitive delays.

Lori Fankhanel is the Founder and President of SPD Canada Foundation, Owner of Sensational Futures a consulting company running workshops on topics that impact children with special needs

GLOW (Girls Leading Others Wisely)

Walker

Diversity and Culture

GLOW strives to provide girls with the self confidence and the skills necessary to become effective and influential leaders. GLOW is a powerful 8 week program designed for girls between the ages of 9-14 and 14-21. Each session utilizes a GLOW Circle to promote discussion about preteen and teen topics, as well as introducing fun and creative physical activity to participants. Girls set personal goals. All aspects of the program are created to strengthen a girls well being, nutritional choices and physical exercise to develop a true sense of self. Come and join us for a sample GLOW class! Information on the GLOW Guide will be provided.

Kim Tackaberry B.A, B. Ed., Specialist in Special Education, Foothills Academy, Calgary, AB.

Foundations to a Successful and Supportive Environment for Youth with FASD

Nakiska

Exceptional Needs

The intent of the workshop is to provide a framework on how to effectively offer holistic supports to youth who have FASD, their families and supports. This will include a brief overview of the program and its components, as well as the long-term outcomes. Presenters will share stories of success from youth who have taken part in the programs, highlighting youth involvement. Participants will learn about the various strategies that have been effective for youth in building natural support networks and increasing their advocacy skills.

As well, presenters will highlight Kaleidoscope as a leading edge program. Kaleidoscope is a Supported Employment program that supports employees with FASD to mentor youth with FASD to live inclusively in their community.

Myles Himmelreich, FASD peer mentor at McMan Youth Family and Community Services

Matt Bolt is FASD peer mentor at McMan Youth Family and Community Services

Joy Bowen-Eyre, Past Program Supervisor, FASD, McMan Youth Family and Community Services

iPads as Part of the Universal Design for Learning Toolkit

Mount Kidd Ballroom A

Mount Kidd Manor

Technology

Have iPads been making their way into your classroom? The Smart Inclusion team at Upper Canada District School Board in Ontario has been exploring how iPads can be used with other technology (i.e. SMART Boards, SMART Tables, Switches) and traditional teaching tools to help ALL students achieve social and academic goals. Come and see how we have used iPads and you will want the apps as part of a Universal Design for Learning Toolkit to support inclusion across the curriculum.

Alex Dunn, Speech-Language Pathologist, Upper Canada District School Board (UCDSB), Oxford Mills, Ontario

CONFERENCE

9:00 – 10:30 a.m.

SATURDAY, OCTOBER 15, 2011

LOCATION

Tools and Strategies for the Inclusive Classroom

**Mount Kidd Ballroom B
Mount Kidd Manor**

Technology

Learn and Play!! Enhance your teaching and excite your learners with engaging tools and strategies which will help meet the diverse needs in your classroom. Bring your own laptop to this session as you will be given a chance to explore the tools introduced.

Sue Helland, Learning and Literacy Strategists, Calgary Board of Education

Tara Macdonald Learning and Literacy Strategists, Calgary Board of Education

**A Different Point of View:
Through the Eyes of a Parent**

**Mount Kidd Ballroom C
Mount Kidd Manor**

Exceptional Needs

Teachers see students during school hours; parents have responsibility for children with exceptional needs on a 24 by 7 basis. For a parent of a child with exceptional needs, that responsibility can be grueling. In this session, Kathryn Burke speaks from the parent's perspective on advocating for a child with exceptional needs, describing the highs and lows of dealing with often overburdened education and health systems. She speaks about angels in the system who make a difference, and how teachers can positively support parents of children with exceptional learning needs.

Kathryn Burke, Executive Director of the Learning Disabilities Association of Alberta and has worked in the health and human services field.

CONFERENCE

11:00 – 12:30 p.m.

Saturday, October 15, 2011

LOCATION

CLOSING KEYNOTE SPEAKER

Olympic Ballroom

TROY PAYNE

Building in Resiliency

Children today are confronted with many adversities that can impact their personal wellness and influence the adults they become. These challenges can change a child's life forever – so can overcoming them. It is a pivotal and beautiful moment in a child's life when they connect with an adult and feel that someone really sees them for the first time.

What can we do as parents, counsellors, educators, and members of our community to ensure that our children lead healthy, harmonious lives? How can we best support our children towards seeing their true potential?

Using the combined power of storytelling and music, "Building in Resiliency" pays homage to those in the helping profession. It demonstrates the power each of us has to make a difference in the lives of others and celebrates this opportunity. Troy's message brings inspiration into fruition for all those who are bright lights in the lives of children.

Troy Payne is an inspirational speaker who took the cards life dealt him and turned them into opportunities to positively impact the lives of children and those who work alongside them. Troy attributes his personal growth to the support of great educators, counsellors, and enriching school programs that opened his eyes to his true potential. Following post-secondary education, Troy became a Child & Youth Care Worker, working in schools and residential treatment centres, counselling youth and their families. Inspired to reach more people, Troy started his company Wellness Realization and since then has connected with over 100,000 people through his presentations.

Carmela Amelio-McCaw



Carmela served as president of the Special Education Council in 2000 and again in 2004. She volunteered over 15 years with the council in various capacities, including Conference Director and Professional Development Chair. Ensuring teachers were provided with professional development opportunities was one of her goals and she gave countless hours to the betterment of our profession.

Teaching students with special needs was Carmela's passion. She was fiercely devoted not only to her students' education but to their achievements in all aspects of life through her involvement with Special Olympics and numerous other committees dedicated to special education. She was employed with Edmonton Catholic Schools and finished her career as Department Head of the Educational Experience Program of St. Joseph's High School.

Carmela passed away peacefully on January 16, 2011 at the age of 55. She continues to be missed by all who knew her. The Special Education Program award will be changed in 2012 to the ***Carmela Amelio-McCaw Special Education Program Award*** to honor the commitment, dedication, and high standards of achievement Carmela strived for each day in her classroom and she advocated for across the province.

REMINDERS

- ✚ Check out time for the Delta Lodge and Mount Kidd Manor is 11:00 a.m.**
 - Video checkout is available
 - Luggage can be stored until you are ready to leave
- ✚ Drop off you completed Exhibitor Passports in the designated locations to win great prizes.**
- ✚ Please complete the Conference evaluation Form and leave it at the Registration Desk.**
- ✚ Special Education Conference 2012 will be held in Kananaskis on October 11 to October 13, 2012.**

CHECK OUT THE DISPLAYS



Alberta TeachersøBook Depository
Dakota Comforts
Davies & Johnson
Education Station
Educational Distributors / McGraw Hill
Enterprises FDMT
Flaghouse
Foothills Educational Materials
Insight Media
Khan Communication Services
Kid Source
Learning Links
National Geographic
Pearson Canada
Scholastic
Secret Resources
Self-Connection Books
Sharps Audio Visual
Spectrum
Stech-Vaughn
Therapy Ware
Usborne Books
Wintergreen
W. P. Puppet

Exhibitor Passport

Visit the Exhibits in the Mount Allan Room, Mount Kidd Manor Foyer & Breezeway and get your passport endorsed from the different exhibitors. Enter your completed passport(s) to enter the draw for great prizes.

Passports are included in the delegate package

List current as of September 15, 2011 – check the announcement board for changes

Maps of The Hotel

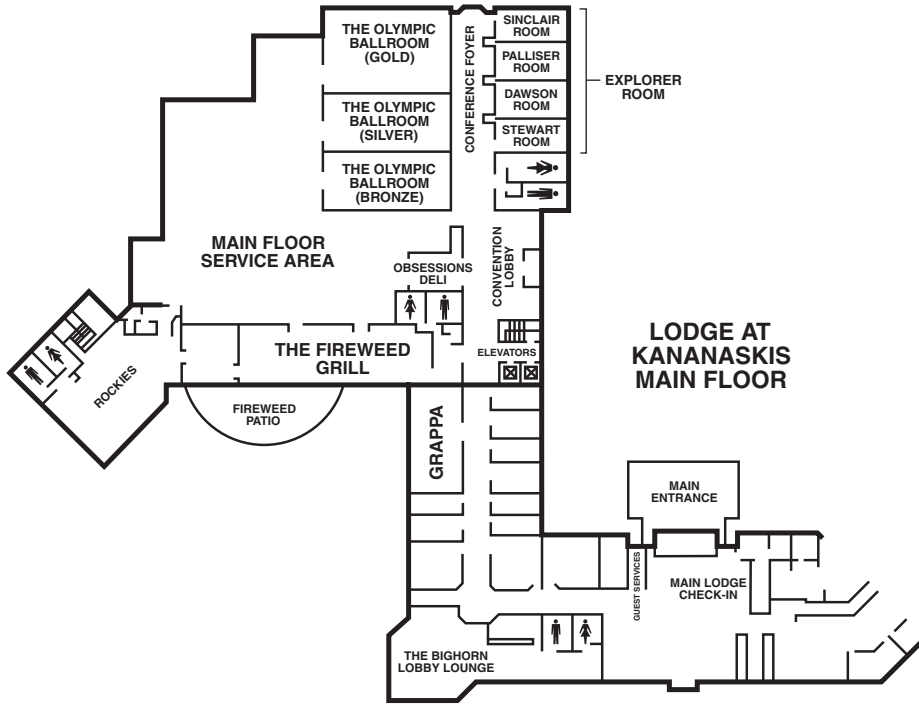

SUMMIT SPA AND FITNESS CENTRE COMPLEX LODGE LOWER LEVEL

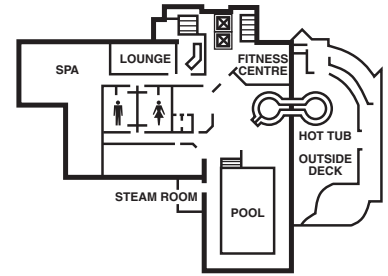

LODGE AT KANANASKIS SECOND FLOOR MEETING ROOMS

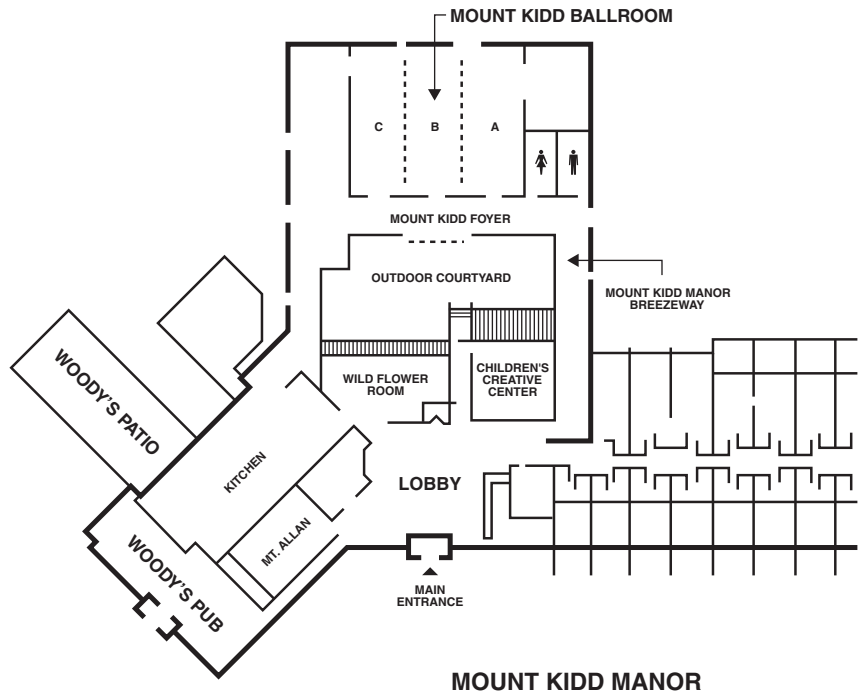
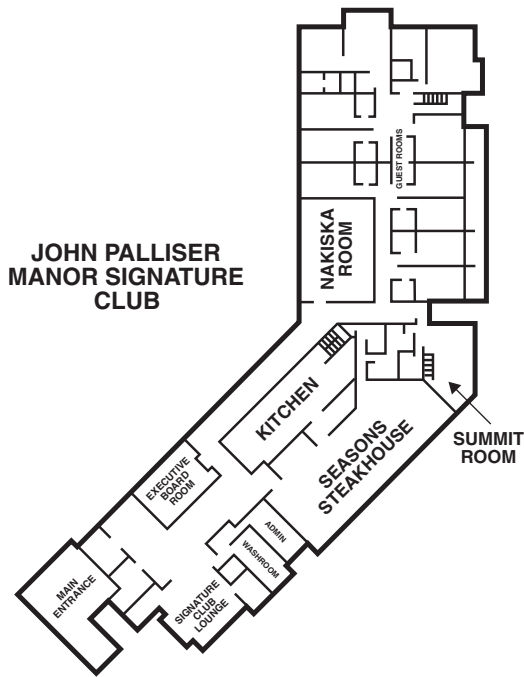



SEC – Celebrating The Challenges

General Information:

- · Olympic Ballroom: Location of Opening, Plenary & Closing sessions
- · Boxed lunches can be picked up outside Grappa in the Main Lodge on Friday
- · Outlet Hours of Operation: dial 51 for reservations/information
 - Big Horn Lounge: 3:00 p.m. - 12:00 a.m.
 - Woodyø Pub: 4:00 p.m. - 2:00 a.m.
 - Obsessions Deli: 7:00 a.m. - 5:30 p.m.
 - In-Room Dining: 7:00 a.m. - 11:00 p.m.
 - Fireweed Grill:
 - Breakfast: 7:00 a.m. - 10:30 a.m. (11:00 a.m. on weekends)
 - Lunch: 11:30 a.m. - 4:00 p.m.
 - Dinner: 5:30 p.m. - 9:30 p.m.
 - Grappa: 5:30 p.m. - 9:30 p.m. on Friday & Saturday
 - Seasons Steakhouse: 6:00 p.m. - 9:00 p.m. on Friday & Saturday
- · Fitness Centre Hours: 6:00 a.m. - 11:00 p.m.
- · Summit Spa: Appointments available 9:00 a.m. - 10:00 p.m.
Call 403-591-6227 to make an appointment
- · Locations for meals if you are on the meal plan:
 - Breakfast: Fireweed Grill, Grappa, Big Horn Lounge & Wildflower room
 - Dinner:
 - Rockies Room: 5:30pm
 - Mt. Kidd Ballroom: 6:30pm
 - Olympic Ballroom: 7:00pm

**Please note that for dinner, you must pre-select a dinner location and time upon check-in.
Seating is limited in each location.**

**Visit the DISPLAYS at
MOUNT ALLAN ROOM, MOUNT KIDD LOBBY AND MOUNT KIDD
BREEZEWAY
Open Times**

Thursday	6:00 p.m. to 8:00 p.m.
Friday	8:00 a.m. to 6:00 p.m.
Saturday	8:00 a.m. to 1:00 p.m.

Special Education Conference 2011 Committee Members

Director.....	Darci Fulton
Conference Chair / Registrar.....	Melanie Clark
Display Coordinator.....	Darryl Weir
Hotel Liaison.....	Glenda Crawford Elaine Bolt
Program Committee.....	Elaine Bolt Hayley Christen Darci Fulton Christine McCrory
Treasurer	Therese Daley
Social Coordinator.....	Amy Godderis
Moderator Coordinator.....	Andy Heaton
Webmaster & Technology	Glenn Goslin
Red Deer Representatives	Hayley Christen Glenda Crawford Susan Parkins

The Special Education Conference 2011 Committee sincerely hopes that you have enjoyed this conference.

Please take time to fill out the following pages and give us some feedback on the conference.

Drive carefully and have a safe trip home.

PLEASE TEAR OUT THE NEXT PAGES AND DROP THEM IN THE BOX AT THE REGISTRATION DESK AT THE END OF THE CONFERENCE.

THANK YOU!



Special Education Conference Evaluation 2011



Keynote Address

The Thursday keynote speaker was:
 Excellent Good Fair

Programs

Overall the session topics were:
 Excellent Good Fair

The Friday keynote speaker was:

Excellent Good Fair

Overall the sessions I attended were:

Excellent Good Fair

The Saturday keynote speaker was: Excellent Good Fair

Overall the conference was:

Excellent Good Fair

<p>Social Events</p> <p>Wine and Cheese</p> <p><input type="checkbox"/> Excellent <input type="checkbox"/> Good <input type="checkbox"/> Fair</p> <p>Dance</p> <p><input type="checkbox"/> Excellent <input type="checkbox"/> Good <input type="checkbox"/> Fair</p>

<p style="text-align: center;">Facilities</p> <p>Online Registration process</p> <p><input type="checkbox"/> Excellent <input type="checkbox"/> Good <input type="checkbox"/> Fair</p> <p>Displays</p> <p><input type="checkbox"/> Excellent <input type="checkbox"/> Good <input type="checkbox"/> Fair</p> <p>Room - Delta Lodge or Mountain Lodge</p> <p><input type="checkbox"/> Excellent <input type="checkbox"/> Good <input type="checkbox"/> Fair</p> <p>Session Rooms</p> <p><input type="checkbox"/> Excellent <input type="checkbox"/> Good <input type="checkbox"/> Fair</p>	<p style="text-align: center;">Favorites</p> <p>Session speaker(s):</p> <p>_____</p> <p>_____</p> <p>_____</p> <p>Session(s):</p> <p>_____</p> <p>_____</p> <p>_____</p> <p>_____</p>
--	--

